

 **ARISTON**
The home of sustainable comfort



**Electric water
heaters
catalogue**





The home of sustainable comfort

As a **leading specialist** in heating and water-heating with over 90 years of history, Ariston understands well the challenges in creating practical and high-performance products and systems that guarantee exceptional levels of comfort and efficiency. That is why it has set itself a new mission – **to give more homes access to sustainable comfort solutions** using less energy and effort.

To this end, it has further strengthened its commitment to delivering **high-quality, renewable and energy-efficient solutions** that can simplify and improve the quality of home life while empowering people to live more sustainably.

By successfully combining its global reach with an in-depth focus on the needs of the different markets where it has a presence, Ariston prides itself in being the home of sustainable comfort: a reference brand trusted worldwide by millions of families and industry professionals longing for advanced thermal comfort solutions that **not only are easy to use and maintain but also use as little energy as possible.**

Our story, driven by your needs

Ariston's continuous growth has been fueled by its commitment to provide people with reliable and highly-efficient comfort solutions to improve and enjoy life at home. Each step of the way we have been driven by the existing and emerging needs of our customers, and our solutions have been conceived with their lifestyle in mind.



'30s

Foundation

Aristide Merloni founds "Industrie Merloni" company in the Marche Region of Italy, and starts the production of weighing scales.

'80s

Heating

We consolidate our market leadership in water heating and the production of boilers begins.

'60s

Water heating

The Ariston brand is launched and the production of electric water heaters begins.



'90s

Global expansion

With the launch in China and Russia, we begin to evolve into a global brand.



'10s

Ariston Comfort Challenge

With this mission, Ariston proved the ability of its products to guarantee exceptional performance, durability and efficiency's levels in every condition, even where it seems impossible. It was a huge challenge, but it was just the beginning.

'00s

Renewable technologies

We successfully develop and launch our new model in heat pump, which marks our development into innovative and sustainable heating technology.



'20s

The home of sustainable comfort

We strengthen our commitment to providing our end-users with products that generate heating and hot water in the most efficient and renewable way possible. A tangible sign of our dedication to respecting everything that surrounds us.



Why choose Ariston?

We are a global **thermal comfort specialist**

Standing out as **global leader in heating and water-heating with more than 90 years of expertise**, Ariston boasts an extensive product and service portfolio equally focused on the provision of renewable and high-efficiency heating and hot water solutions. With its

proven ability to meet the local needs of every country where it has a presence, our company is **trusted and welcomed by millions of families around the world**, while also being the **preferred choice for thousands of professionals**.



We are masters of **renewable and high-efficiency solutions**

Sustainable comfort lies at the heart of our company and our commitment is to provide our customers with products and systems that **generate heating and hot water in the most efficient and renewable way possible**, whatever their energy source. Choosing Ariston means gaining access to a broad and comprehensive range of high-performance and easy-to-use solutions that not only will play a significant role in the reduction of energy bills, but also represent the perfect upgrade for a more sustainable home thanks to **smart connectivity and the latest technologies** being developed for environmentally-friendly heating and water heating.



Wide offer in last generation **heat pumps for heating and hot water and solar**

2.5%

of revenues invested annually in **R&D** with growing focus on renewable products*

Efficient

hybrid systems

tailored for every need

79%

of turnover from innovative products (younger than 5 years)*

Commitment to frontier R&D

(Hydrogen, gas absorption heat pump, demand-response, natural refrigerants)

Connectivity in all Heating and Water Heating segments

*The data refer to Ariston group, worldwide portfolio of solutions.

We are dedicated to enduring quality

Our products and solutions are made to last, so are of the highest quality. We achieve this by using the best components and materials available and through rigorous checks taking place before, during and after production. For maximum serenity, **every product we sell comes with a solid warranty**. But not only that; anyone purchasing one of our products can be reassured there will always be a point of contact available to deal with anything. **High standards of quality apply to all our processes and functions**: our facilities are involved in a continuous performance and quality monitoring process, constantly improving every aspect of manufacture, plant maintenance and distribution logistics.



100%

checked and tested products

>95%

of our products require no technical interventions in their first 5 years of service*

High-quality
after-sales service
always available

Effective
warranty
guarantees

*The data refer to Ariston group, worldwide portfolio of solutions.

We are champions of **home and planet**

Italian in origin, since its founding in 1930 Ariston has been synonymous with innovation and sustainability and has been **driven by the mission to make every home a haven of comfort** – while maintaining a strong focus on the environment. As a leading global brand, we now feel at home

in almost every part of the world. And because we see **the world as the home we all share**, we develop products and solutions that represent an accessible and effective way for anyone to improve and enjoy life at home while making more responsible and energy-conscious choices.



Believe in sustainability

Our purpose is to provide **everyone, in every corner of the world, with high-quality heating and water heating solutions, while protecting the environment.**

To this end, we have placed energy efficiency and technologies using energy from renewable sources at the centre of our sustainable growth strategy, thus acting consistently with the sustainable

development goals endorsed by the General Assembly of the United Nations.

This commitment is reflected in the effort we invest in developing efficient and sustainable products, solutions and processes that can make a decisive contribution to reducing energy consumption and environmental impact without sacrificing comfort.



SUSTAINABLE DEVELOPMENT GOALS



The economic, social and environmental impacts generated through Ariston Thermo Group's operations contribute towards 9 of the 17 sustainable development goals, including:

Sustainable cities and communities

Ariston Thermo Group's commitment to energy-efficient solutions will enable citizens to use clean energy to its fullest potential. Replacing low-efficiency products with Ariston's new high-efficiency technologies will allow to curb carbon dioxide emissions by more than 3,4 Mln tons by 2022*.

Responsible consumption and production

All of our production plants around the world are at the centre of Ariston Thermo Group's energy efficiency plan. This consists in a long-term strategy that in 2019 allowed the Group to achieve a remarkable result: over 10,000 tons of CO2 equivalent avoided thanks to the energy efficiency of the production processes.

Climate action

During 2019 the Ariston Comfort Zone, a modular house equipped with Ariston's most advanced and efficient technology, enabled a group of researchers from the University of Copenhagen tasked with studying how climate change is affecting the Arctic ecosystem to conduct 22 new studies.



Pre-Sales and After-Sales technical support

Our services

We are always at your side In all phases of the realization of a project.

From the design of a plant, to the construction of the system itself and even after commissioning, a team of Ariston specialists is constantly available to provide support and assistance.

Pre-Sales

A team of technicians and engineers offer their support and their experience in the design of key-on-hand solutions, providing them with products, designs and maintenance services.

Technical Consultancy Center

The Technical Consultancy Center provides every day specialist consultancy and timely responses on the technical characteristics of installations.

The technical team is the right interlocutor with whom interface for design and maintenance of complex plants.

After-Sales

Our qualified Service Network provides technical support for startup, maintenance, troubleshooting and repair interventions, by remote and on field as well.

Our mission is to deliver high level of service, through solid know-how and quality of genuine spare parts, in order to ensure the Ariston products performance, long term reliability and make them exceed the Customer expectations.

ERP

Are you up-to-date with the new regulations?



Since 26 September 2015, the new European Union regulations define minimum efficiency and energy labelling requirements for boilers, heat pumps, micro-cogeneration, water heaters and hot water tanks.

On 26 September 2018 have been introduced new limits of NO_x emissions, in addition to the efficiency limits already in force. The NO_x limits have been applied to products placed on the market starting from 26 September 2018. Products purchased before that date and already in retail outlets or distribution warehouses can continue to be sold and installed, even though they do not comply with the new requirements.

26.09.2015



A++ (space heating) / **A** (water heating)

Compulsory labelling on space heating and water heating products (energy class)

2017

A+

introduced for domestic hot water production

26.09.2018

26.09.2019

A+++

introduced for space heating



Minimum performance requirements for space heating and domestic hot water production

New limits for NO_x emissions < 56 mg/kWh (for gas fuels)

In this catalogue



Medium capacity electric storage water heaters

- 24 / Velis Evo Plus
- 25 / Velis Evo
- 30 / Lydos Plus
- 31 / Lydos Eco
- 32 / Lydos R
- 34 / Pro1 Eco
- 36 / Pro1 R
- 38 / Pro R Hidden
- 39 / Blu R



Small capacity electric storage water heaters

- 44 / Andris Lux Eco
- 45 / Andris Lux
- 46 / Andris RS
- 47 / Blu R



Big capacity electric storage water heaters

- 49 / Ari Top
- 50 / Ari
- 51 / Ari Stab



Electric instantaneous water heaters

- 57 / Aures Slim
- 58 / Aures Slim Flow
- 60 / Aures Multi



Commercial electric water heaters

- 62 / Ti Sti
- 63 / Es Extra
- 65 / Es Extra 5000

Equivalent Capacity value mentioned in this catalogue identifies a product category. Storage volume is specified in technical documents included in the product.

A close-up photograph of a modern, circular shower head with a brushed metal finish. Water is spraying from the shower head in multiple streams, creating a misty effect. The background is a solid, light blue color. In the bottom left corner, there is a red, rounded triangular shape containing white text.

**Medium
capacity electric
storage water
heaters**



Advanced technologies meet increasingly intelligent performances and unmatched energy savings. By using different energy sources, Ariston storage water heaters will ensure hot water comfort to all your family.

- ▲ Velis range
- ▲ New Lydos range
- ▲ Pro1 R
- ▲ Blu R

The electric storage water heater range
designed to provide
The maximum saving and total comfort

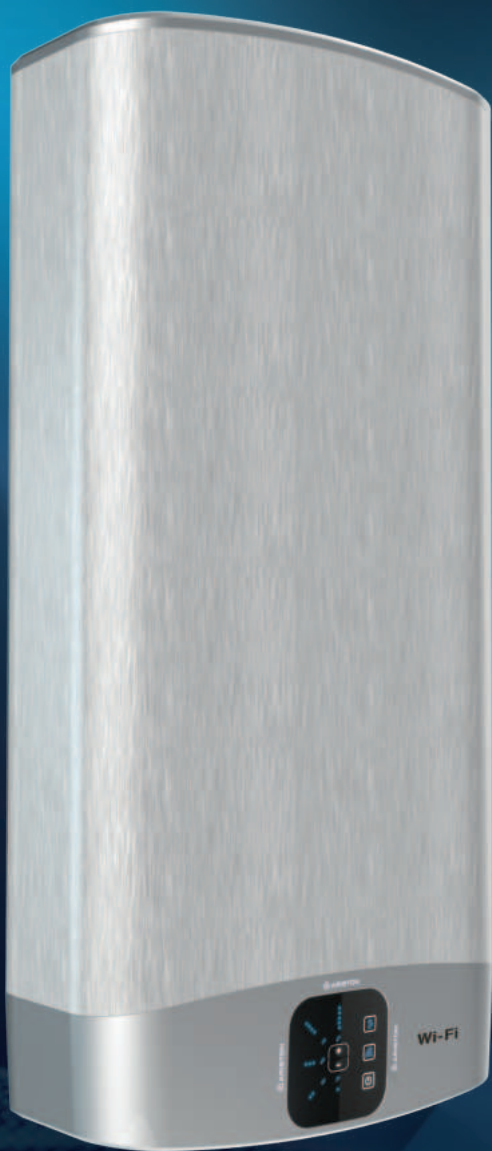

VELIS EVO PLUS
/ Performances and style



LYDOS ECO
/ Exclusive Design



PRO1 ECO

/ ECO EVO function
for high energy saving



PRO 1 R

/ With external temperature
setting

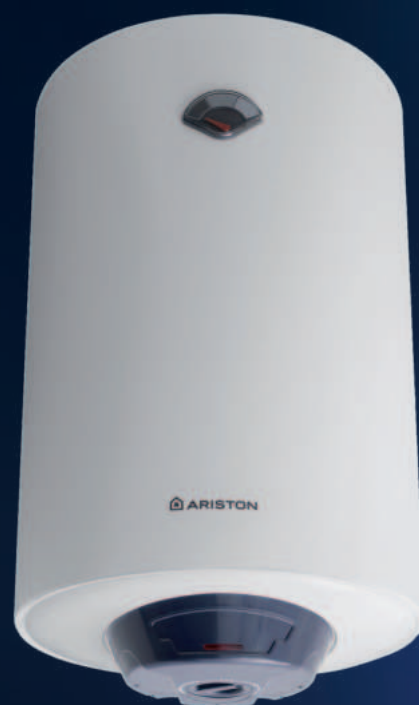

BLU R

/ Maximum Saving

Velis EVO PLUS

Hot water in record time

High-quality materials, flat shape and modern sleek lines enclosing the most advanced technologies in the sector. Thanks to the ability to deliver hot water in just 50 minutes, **Velis Evo Plus** is the perfect water heater for whoever wants an amazing product on every level, management included. With the SMART BLUE TECH touch screen display, you can now check how many showers are available and the waiting time for the next shower with Velis Evo Plus. You can also schedule two moments a day in which you want to have hot water ready for you.

Designed by **Umberto Palermo**, **Velis Evo** embodies the essence of Italian design, and will fit snugly into any bathroom as a real piece of furniture.

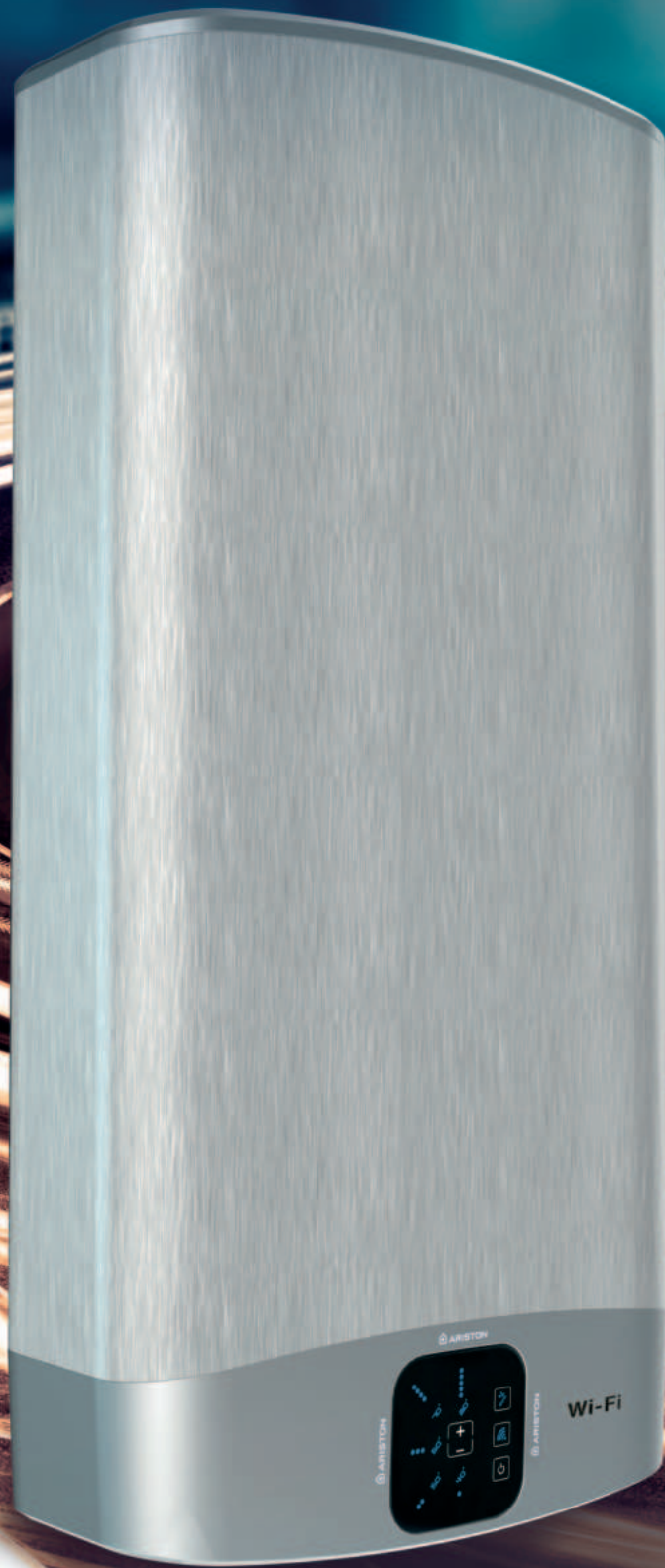

Double Tank technology

Hot shower is ready quicker

The innovative **Double Tank Technology** heats water faster than a standard round water heater. Each tank is equipped with a specific heating element and can therefore be heated independently, thus ensuring the ideal amount of hot water ready to use.

This particular technology allows you to have hot water for your first shower **in just 50 minutes***. Moreover, this water heating system ensures maximum silence.

* With reference to a 40 l shower at 40°C and inlet water temperature at 10°C.

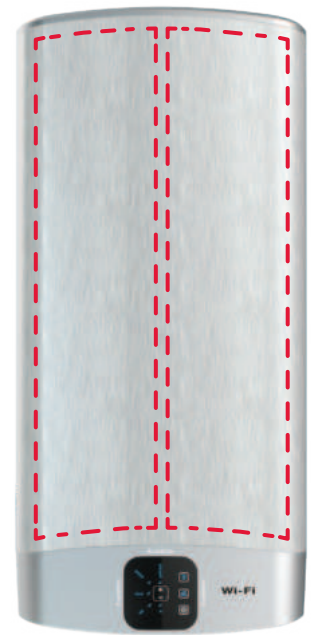

Dry Heating technology

Additional safety

Thanks to the **Dry Heating Technology****, heating elements are encased in dedicated tubes to avoid direct contact with water. This provides additional safety against short-circuit and increased protection against limescale thus allowing a simple and quick replacement of heating element without draining the tank.

ECO EVO function

The hot water you need when you need it



The innovative **Eco Evo function powered by CoreTECH** memorizes your daily habits to give you hot water only when you need, thus allowing you to save energy and reduce costs.

* Estimated saving up to 25% on daily basis, compared to Ariston standard mechanical products.

**Available for specific models.

Aqua Ariston NET App

Smartly connected to you



The Ariston Net App keeps track of your water use habits in order to ensure that only the needed amount of energy is used, thus saving electricity and lowering your electric bill. **By connecting the product to the Wi-Fi and using the App, you can save energy up to 25%***. to monitor your consumption and save energy, daily, monthly or annual energy consumption reports expressed in kWh are available for consultations.

FREE DOWNLOAD

Download Aqua Ariston NET App now for free from:



Blue Tech touch display

It's all in the screen



The smart blue tech touch screen display provides detailed information on:

Showers available

Velis WI-FI clearly shows the water temperature on the display, while the number of showers can be viewed in the app.

ECO EVO function

High energy saving is achieved thanks to the self-adaptive function ECO EVO, which can be easily activated on the control panel.

Wi-Fi connection

Wi-fi can be activated by simply touching the dedicated button. Connecting your water heater with your smartphone is very easy.

Multi-position

Vertical and horizontal installation

Elegant and versatile, Velis Evo can be installed both horizontally and vertically. The display will fit with both configurations.



Velis Evo Plus



Flat and elegantly designed smart electric water heater

- / Superior design to match your home: exclusive Italian design, flat form factor and multiposition installation
- / Increase energy saving: up to 14% thanks to ECO EVO function which learn habits and optimize production

Energy Class



Features

- / Smart touch screen Blue Tech display showing the number of showers available and waiting time for the next shower
- / Eco Evo powered by CoreTECH
- / Daily programming
- / Ecological polyurethane insulation
- / ABS safety system in case of energy or water failures
- / Titanium enamelled double tank for a long durability
- / Multiposition installation
- / Only 27 cm deep
- / Exclusive Italian design
- / Silver metal finishing, to blend and fit the furniture of your bathroom



* Check if local product code is enabled for connectivity

TECHNICAL DATA

		50	80	100
Nominal Capacity	l	50	80	100
Installation		Multiposition (V/H)	Multiposition (V/H)	Multiposition (V/H)
Power	kW	1,5	1,5	1,5
Voltage	V	230	230	230
Heating time ($\Delta T=45^{\circ}C$)	hh:mm	01:43	02:37	03:19
Max working pressure	bar	8	8	8
Max working temperature	$^{\circ}C$	80	80	80
Weight	kg	21,7	28,3	32,2
Water protection	IP	X4	X4	X4

DIMENSIONS

	mm	776	1066	1251
a	mm	776	1066	1251
b	mm	405	695	880

CODE

	3626148	3626149	3626150
ENERGY RELATED PRODUCTS	3626148	3626149	3626150

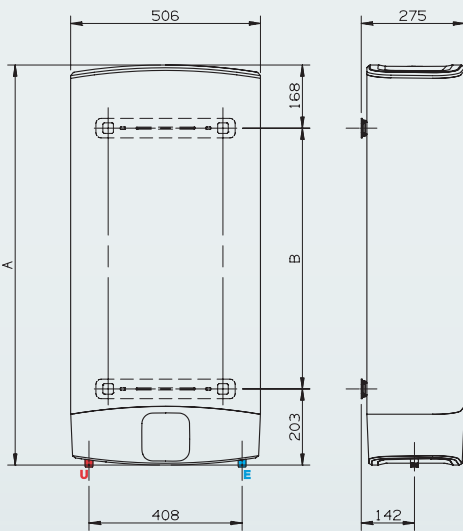

KEY

- E \ Cold water inlet G 1/2"
- U \ Hot water outlet G 1/2"

NOTE: The Nominal capacity listed in this catalogue identifies the product category. The actual product capacity is listed in the relative technical documentation.

Velis Evo



Flat and elegantly designed electric water heater

- / Superior design to match your home: exclusive italian design, flat form factor and multiposition installation
- / Increase energy saving: up to 14% thanks to ECO EVO function which learn habits and optimize production

Energy Class



Features

- / Digital temperature regulation
- / Shower ready and ECO-EVO function.
- / Titanium glasslines inner tank tested at 16 bar
- / Enamelled heating element and two magnesium anode
- / Only 27 cm deep
- / LED display



TECHNICAL DATA

		50	80	100
Nominal Capacity	l	50	80	100
Installation		Multiposition (V/H)	Multiposition (V/H)	Multiposition (V/H)
Power	kW	1,5	1,5	1,5
Voltage	V	230	230	230
Heating Time ($\Delta T=45^{\circ}C$)	hh:mm	01:30	02:15	02:50
Time needed for 1st Shower	min	50	50	50
Max working pressure	bar	8	8	8
Max operating temperature	$^{\circ}C$	80	80	80
Weight	kg	22	28	32
Water protection	IP	X4	X4	X4

DIMENSIONS

	mm	776	1066	1251
a	mm	776	1066	1251
b	mm	405	695	880
c	mm	506	506	506

*Temperature set at 65°C

CODE

	3626145	3626146	3626147
Energy class	B	B	B
Tapping profile	M	M	M

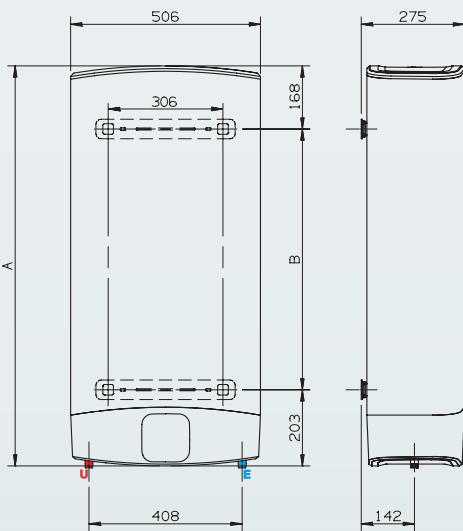

KEY

- E \ Cold water inlet G 1/2"
- U \ Hot water outlet G 1/2"

NOTE: The Nominal capacity listed in this catalogue identifies the product category. The actual product capacity is listed in the relative technical documentation.

Lydos range

The brand new hot water experience



WaterPlus technology

Enjoy the comfort of an extra hot shower



The ground-breaking patented **WaterPlus technology** keeps the incoming cold water at the bottom of the tank, thus **reducing the mix of cold and stored hot water**.

This allows up to **16% more hot water available***, to let you enjoy the comfort of an extra hot shower anytime you want.

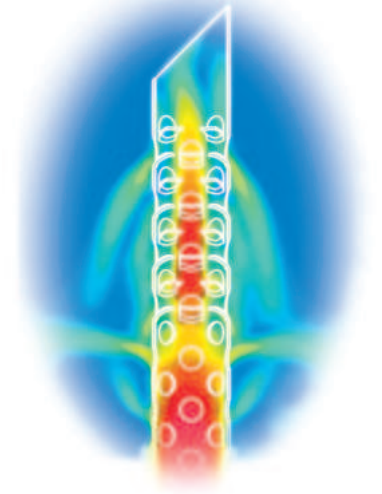

ECO EVO function

The hot water you want, anytime



The innovative **Eco Evo function powered by CoreTECH** memorizes your daily habits to give you hot water only when you need, thus allowing you to save energy and reduce costs.

Maximum saving at home

Operating in compliance with top standards on energy efficiency within the electric water heating category, Eco Evo function is so smart that it learns from your habits and recalls when and how much hot water you use.

This spares you pointless waste, enabling you to **save up to 259 kWh per year**** and ensuring a 14% saving on your electric bill.

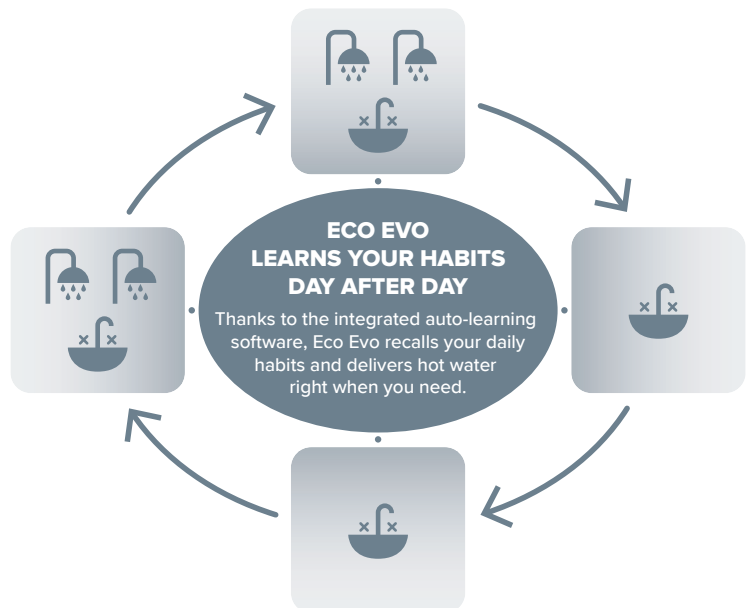

T-MAX

Hot water quickly

Thanks to the new functions **T-MAX** and **Shower Ready** it is possible to speed up the production of hot water and visualize the number of hot shower on the display***.

* Maximum estimated saving, depending on models. Comparison made using V40 test results at maximum operating temperature between current ATG products and new ATG products equipped with WaterPlus Technology.

** Estimated savings vs traditional electrical water heater based on the average European net demand of hot water (2007 VHK Ecodesign WH study). Savings change depending on product's capacity. Referred to B Class products.

*** Visualization of the number of showers available in real time only for Lydos Plus (on the digital display) and Lydos Wi-Fi (on the App).

Titanshield technology

Every day like the first day



Ariston has been always committed to developing products that last through time. For this reason, the water heater is equipped with the exclusive **TitanShield**, Ariston's double action technology that offers best tank protection with **titanium enameling** and **enhanced magnesium anode**.

Strong protection against corrosion

The inner surface of the tank is coated with a **titanium enamel**, while the **magnesium anode** prevents corrosion of the tank's inner surface and prolongs the life of your water heater.

Mineral barrier against limescale

Thanks to its unique properties, titanium naturally produces a dioxide film that **prevents limescale forming** on the inner surface of the tank.

Total Safety

Safe at all times



The **Absolute safety system** is a set of functions preserving the good functioning of the product in case of energy or water failures.

The safety package includes:

- / **Anti overheating:** in the event of an error, the high-precision electronic thermostat will shut off the heating cycle, thus **avoiding risk of burning out** due to overheating the element.
- / **Anti freezing:** in cold areas, frozen water can damage the water heater severely. This function keeps the water at a **minimum temperature of 5°C** even when the unit is turned off.
- / **Dry heating auto-diagnosys:** should there be a **lack of water in the tank**, the water heater is able to **detect this and prevents the heating cycle** from starting and damaging the unit.
- / **Anti legionella:** once a month, the unit will automatically raise the temperature of the water stored inside it to 65°C, in order to **eliminate the risk of legionella bacteria developing** and **keep the water healthy**.

T-FLEX

Heating power is in your hands



The new **T-FLEX software** optimally allows to easily change the heating power.

Whenever needed, it allows to **boost the water heating's speed and power**, or to slow them down.

/ **Multi-power management:** possibility to choose different power of the heating element.

/ **Low power function*:** lower the power of the heating element. A perfect solution when limited electrical power is available and for energy saving.

/ **Constant temperature:** precise and constant temperature management.

Italian design

Bring a masterpiece into your home

A contemporary and captivating creation by the Italian designer **Umberto Palermo**. Engineered and manufactured **in Italy** with high quality materials, Lydos will enter your house as a unique interior design piece.

All-round quality

Rounded shape, sleek aesthetic finishes and no visible screws. All enhanced with **new materials** for optimised performance.

User friendly interface

The **advanced hi-tech display** located at the front of the product resembles a smartphone screen and provides easy and fluent interaction together with practical temperature management.



Lydos Plus



WATER PLUS



ECO EVO FUNCTION



ABSOLUTE SAFETY SYSTEM



SHOWER READY



TITAN SHIELD



ENERGY EFFICIENT



ITALIAN DESIGN



DIGIT DISPLAY

Advanced electric storage water heater

- / High performances: Up to 16% more hot water available with Waterplus technology
- / Increase energy saving: up to 14% thanks to ECO EVO function which learn habits and optimize production

Energy Class



Features

- / LCD display
- / Daily programming
- / Shower ready and remaining heating time function
- / Oversized magnesium anode
- / Complete ABS safety system



TECHNICAL DATA

		50 V 1,8K EN EU	80 V 1,8K EN EU	100 V 1,8K EN EU
Nominal Capacity	L	50	80	100
Installation		V	V	V
Power	KW	1,8	1,8	1,8
Voltage	V	230	230	230
Heating time ΔT 45°C	hh:mm	01:27	02:11	02:46
Heat dispersion 65°C	KWh/24h	0,99	1,35	1,56
Max working pressure	bar	8	8	8
Max working temp	°C	80	80	80
Weight	Kg	16	20,5	24
Water protection	IP	IPX3	IPX3	IPX3

DIMENSIONS

A	mm	528	733	885
---	----	-----	-----	-----

CODE

	3201869	3201870	3201871
Energy class	B	B	B
Tapping profile	M	M	M

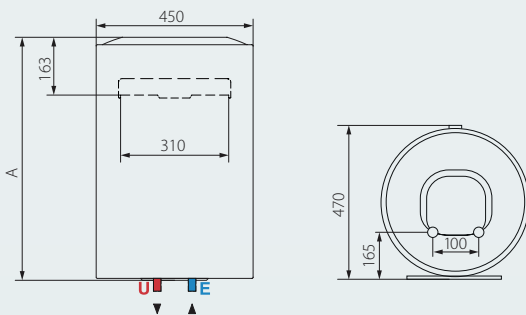

KEY

- E \ Cold water inlet G 1/2"
- U \ Hot water outlet G 1/2"

NOTE: The Nominal capacity listed in this catalogue identifies the product category. The actual product capacity is listed in the relative technical documentation.

* Patented in Spain, patent pending in IT, FR, TK, RU, CN, VN, UAE

** Maximum estimated saving, depending on models. Comparison made using V40 test results at maximum operating temperature between current ATG products and new ATG products equipped with WaterPlus Technology.

Lydos Eco



Advanced electric storage water heater

- / High performances: Up to 16% more hot water available with Waterplus technology
- / Increase energy saving: up to 14% thanks to ECO EVO function which learn habits and optimize production

Energy Class



Features

- / LED Display
- / Shower ready
- / Oversized magnesium anode
- / Complete ABS safety system



1,8 kW - TECHNICAL DATA

		50 V 1,8K EU	80 V 1,8K EU	100 V 1,8K EU
Nominal Capacity	L	50	80	100
Installation	V	V	V	V
Power	KW	1,8	1,8	1,8
Voltage	V	230	230	230
Heating time (T=45 degree celsius)	hh:mm	01:27	02:11	02:46
Heat dispersion at 65 degree celsius	KWh/24h	0,99	1,35	1,56
Max working pressure	bar	8	8	8
Max working temperature	°C	80	80	80
Weight	kg	16	20,5	24
Water protection	IP	IPX3	IPX3	IPX3

DIMENSIONS

A	mm	528	733	885
---	----	-----	-----	-----

CODE

	3201857	3201858	3201859
Energy class	B	B	B
Tapping profile	M	M	M
With Plug and Cable	3201885	3201887	3201889

2 kW - TECHNICAL DATA

		50 V 2K EU	80 V 2K EU	100 V 2K EU
Nominal Capacity	L	50	80	100
Installation	V	V	V	V
Power	KW	2	2	2
Voltage	V	230	230	230
Heating time (T=45 degree celsius)	hh:mm	01:18	01:58	02:29
Heat dispersion at 65 degree celsius	KWh/24h	0,99	1,35	1,56
Max working pressure	bar	8	8	8
Max working temperature	°C	80	80	80
Weight	kg	16	20,5	24
IP Class	IP	IPX3	IPX3	IPX3

DIMENSIONS

A	mm	528	733	885
---	----	-----	-----	-----

CODE

	3201860	3201861	3201862
Energy class	B	B	B
Tapping profile	M	M	M

NOTE: The Nominal capacity listed in this catalogue identifies the product category. The actual product capacity is listed in the relative technical documentation.

* Patented in Spain, patent pending in IT, FR, TK, RU, CN, VN, UAE

** Maximum estimated saving, depending on models. Comparison made using V40 test results at maximum operating temperature between current ATG products and new ATG products equipped with WaterPlus Technology.

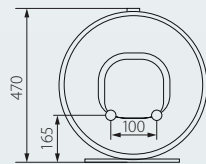
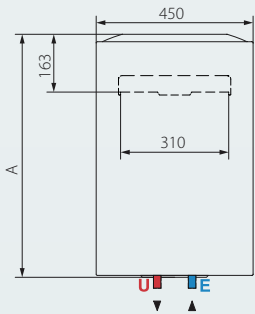

KEY

- E \ Cold water inlet G 1/2"
- U \ Hot water outlet G 1/2"

Lydos R



High quality electric storage water heater

/ High performances: Up to 16% more hot water available with Waterplus technology

Features

- / External temperature setting
- / Double safety thermostat
- / Oversized magnesium anode
- / High quality titanium tank
- / Compliant with top ESWH regulations

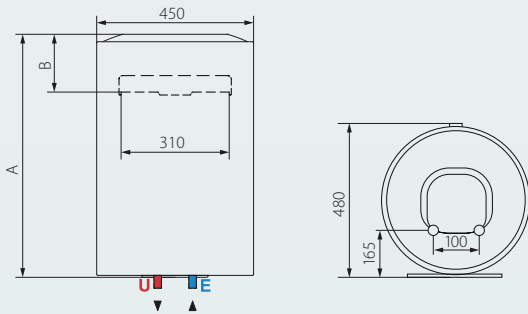

KEY

- E \ Cold water inlet G 1/2"
- U \ Hot water outlet G 1/2"



DIMENSIONS

		LYDOS R 50 V	LYDOS R 80 V	LYDOS R 100 V
1.5 kW				
A	mm	538	743	895
B	mm	163	163	163
3 kW				
				LYDOS R 100 V
A	mm			913
B	mm			181

NOTE: The Nominal capacity listed in this catalogue identifies the product category. The actual product capacity is listed in the relative technical documentation.

* Patented in Spain, patent pending in IT, FR, TK, RU, CN, VN, UAE

** Maximum estimated saving, depending on models. Comparison made using V40 test results at maximum operating temperature between current ATG products and new ATG products equipped with WaterPlus Technology.



WATER PLUS



EXTERNAL TEMPERATURE REGULATION



DOUBLE SAFETY THERMOSTAT



ENERGY EFFICIENT



TITAN SHIELD



ITALIAN DESIGN

1,5 kW - TECHNICAL DATA

LYDOS R 50 V

LYDOS R 80 V

LYDOS R 100 V

LYDOS R 100 V

Nominal Capacity	L	50	80	100	100
Installation		V	V	V	V
Power	KW	1,5	1,5	1,5	3.0
Voltage	V	220-240	220-240	220-240	220-240
Heating time (T=45 degree celsius)	hh:mm	01:45	02:37	03:19	03:19
Heat dispersion at 65 degree celsius	KWh/24h	0,99	1,35	1,56	1,56
Max working pressure	bar	8	8	8	8
Max working temperature	°C	75	75	75	75
Weight	kg	16	20,5	24	24
IP Class	IP	IPX3	IPX3	IPX3	IPX3

CODE

CODE	3201825	3201827	3201829	3201933
UAE	3201428	3201429	3201430	-



Pro1 Eco



All-round electric storage water heater

- / High performances: Up to 16% more hot water available with Waterplus technology
- / Increase energy saving: up to 14% thanks to ECO EVO function which learn habits and optimize production

Energy Class



Features

- / Electronic Display
- / Manual temperature setting
- / Shower ready icon
- / Magnesium anode

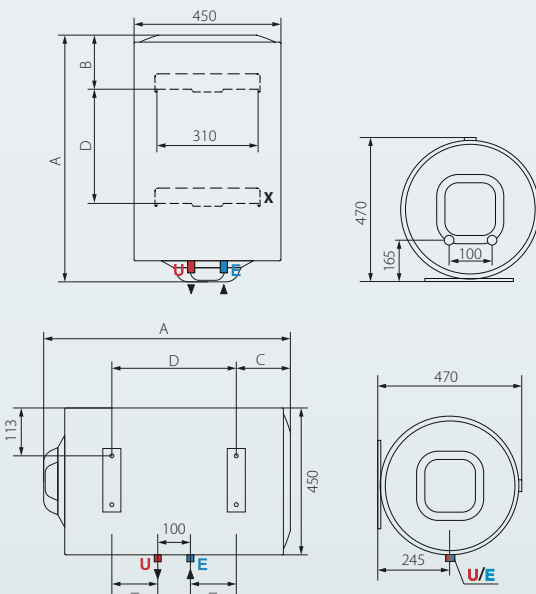

KEY

- E \ Cold water inlet G 1/2"
- U \ Hot water outlet G 1/2"
- X \ Additional bottom fixing bracket only for 150 Lt model



DIMENSIONS

1,2 kW		PRO1 ECO 50 H 1,2K				
A	mm	553				
C	mm	163				
D	mm	159				
1,5 kW		PRO1 ECO 50 V 1,5K	PRO1 ECO 80 V 1,5K	PRO1 ECO 100 V 1,5K	PRO1 ECO 80 H 1,5K	PRO1 ECO 100 H 1,5K
A	mm	553	758	913	758	913
B	mm	163	163	163	-	-
C	mm	-	-	-	178	178
D	mm	-	-	-	334	486

NOTE: The Nominal capacity listed in this catalogue identifies the product category. The actual product capacity is listed in the relative technical documentation.

* Patented in Spain, patent pending in IT, FR, TK, RU, CN, VN, UAE

** Maximum estimated saving, depending on models. Comparison made using V40 test results at maximum operating temperature between current ATG products and new ATG products equipped with WaterPlus Technology.



WATER PLUS



ECO EVO FUNCTION



ABSOLUTE SAFETY SYSTEM



SHOWER READY



TITAN SHIELD



DISPLAY ECO



HIGH EFFICIENCY INSULATION



ITALIAN DESIGN

1,2 - 1,5 kW - TECHNICAL DATA		PRO1 ECO 50 V 1,5K	PRO1 ECO 80 V 1,5K	PRO1 ECO 100 V 1,5K	PRO1 ECO 50 H 1,2K	PRO1 ECO 80 H 1,5K	PRO1 ECO 100 H 1,5K
-------------------------------	--	--------------------	--------------------	---------------------	--------------------	--------------------	---------------------

Installation		V	V	V	H	H	H
Nominal Capacity	L	50	80	100	50	80	100
Max working pressure	bar	8	8	8	8	8	8
Power	KW	1,5	1,5	1,5	1,2	1,5	1,5
Voltage	V	220-240	220-240	220-240	220-240	220-240	220-240
IP class	IP	IPX3	IPX3	IPX3	IPX1	IPX1	IPX1
Max working temp	°C	80	80	80	80	80	80
Heat dispersion 65°C	KWh/24h	0,99	1,35	1,56	1,2	1,48	1,65
Heating time ΔT 45C	hh:mm	01:45	02:37	03:19	02:11	02:37	03:19
Weight	Kg	16	20,5	24	16	20,5	24

CODE

3201821

3201822

3201823

3201425

3201426

3201514



NOTE: The Nominal capacity listed in this catalogue identifies the product category. The actual product capacity is listed in the relative technical documentation.

Pro1 R



MADE IN ITALY



7 YEARS WARRANTY



WATER PLUS



EXTERNAL TEMPERATURE REGULATION



DOUBLE SAFETY THERMOSTAT



TITAN SHIELD



HIGH EFFICIENCY INSULATION



Electric storage water heater

/ High performances: Up to 16% more hot water available with Waterplus technology

Features

- / Compliant with top regulations
- / External temperature setting
- / Double safety thermostat
- / Robust insulation material (polyurethane)
- / Magnesium anode to fight corrosion
- / High quality titanium enameled tank
- / 7 years warranty
- / Designed in Italy
- / Modern shape with "Ariston wave"



علامة الجودة الإماراتية
Emirates Quality Mark

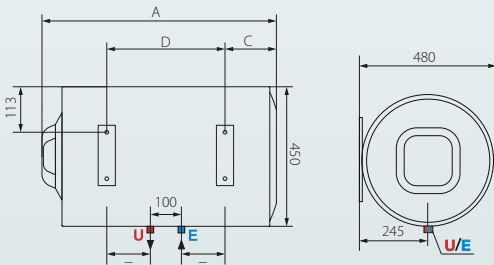
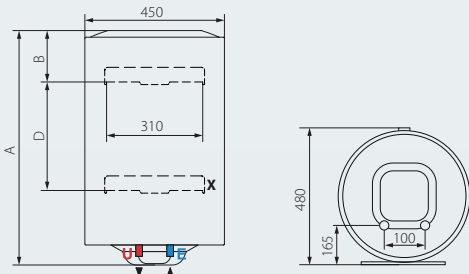

KEY

- E \ Cold water inlet G 1/2"
- U \ Hot water outlet G 1/2"
- X \ Additional bottom fixing bracket only for 150 Lt model



DIMENSIONS

1,5 kW	PRO1 R 50 V	PRO1 R 80 V	PRO1 R 100 V	PRO1 R 50 H	PRO1 R 80 H	PRO1 R 100 H
A mm	543	748	900	543	748	900
B mm	163	163	163	-	-	-
C mm	-	-	-	163	178	178
D mm	-	-	-	159	334	486
1,8 kW	PRO1 R 50 V 1,8K	PRO1 R 80 V 1,8K	PRO1 R 100 V 1,8K	PRO1 R 80 H 1,8K	PRO1 R 100 H 1,8K	
A mm	543	748	900	748	900	
B mm	163	163	163	-	-	
C mm	-	-	-	178	178	
D mm	-	-	-	334	486	
2 kW	PRO1 R 50 V 2K	PRO1 R 80 V 2K	PRO1 R 100 V 2K	PRO1 R 80 H 2K		
A mm	543	748	900	748		
B mm	163	163	163	-		
C mm	-	-	-	178		
D mm	-	-	-	334		
3 kW	PRO1 R 100 H					
A mm	900					
C mm	178					
D mm	486					

NOTE: The Nominal capacity listed in this catalogue identifies the product category. The actual product capacity is listed in the relative technical documentation.

* Patented in Spain, patent pending in IT, FR, TK, RU, CN, VN, UAE

** Maximum estimated saving, depending on models. Comparison made using V40 test results at maximum operating temperature between current ATG products and new ATG products equipped with WaterPlus Technology.

Pro1 R

50 L - TECHNICAL DATA		PRO1 R 50 H	PRO1 R 50 H	PRO1 R 50 V	PRO1 R 50 V
Nominal Capacity	L	50	50	50	50
Installation		H	H	V	V
Size		Regular	Regular	Regular	Regular
Power	kW	0.8	1.2	1.5	2
Voltage	V	220 - 240	220 - 240	220 - 240	230
Heating time ($\Delta T=45^{\circ}\text{C}$)	h.min	3.13'	2.09'	1.43'	1.17'
Heat dispersion at 65°C	kWh/24h	1.20	1.02	0.99	0.99
Max working pressure	bar	8	8	8	8
Max working temperature	$^{\circ}\text{C}$	75	75	75	75
Weight	kg	17	17	17	17
Class	IP	IPX1	IPX1	IPX3	IPX3
CODE (UAE)		3201519	3201980	3201977	
CODE			3201830	3201824	3201810

80 L - TECHNICAL DATA		PRO1 R 80 H	PRO1 R 80 H	PRO1 R 80 H	PRO1 R 80 H	PRO1 R 80 V	PRO1 R 80 V
Nominal Capacity	L	80	80	80	80	80	80
Installation		H	H	H	H	V	V
Size		Regular	Regular	Regular	Regular	Regular	Regular
Power	kW	0.8	1.2	1.5	2	1.5	2
Voltage	V	220 - 240	230	220 - 240	230	220 - 240	230
Heating time ($\Delta T=45^{\circ}\text{C}$)	h.min	4.55'	3.17'	2.37'	1.58'	2.37'	1.58'
Heat dispersion at 65°C	kWh/24h	1.48	1.48	1.48	1.48	1.35	1.35
Max working pressure	bar	8	8	8	8	8	8
Max working temperature	$^{\circ}\text{C}$	75	75	75	75	75	75
Weight	kg	22	22	22	22	22	22
Class	IP	IPX1	IPX1	IPX1	IPX1	IPX3	IPX3
CODE (UAE)		3201522		3201981		3201978	
CODE			3201920	3201831	3201813	3201826	3201811

100 L - TECHNICAL DATA		PRO1 R 100 H	PRO1 R 100 H	PRO1 R 100 H	PRO1 R 100 H	PRO1 R 100 V	PRO1 R 100 V
Nominal Capacity	L	100	100	100	100	100	100
Installation		H	H	H	H	V	V
Size		Regular	Regular	Regular	Regular	Regular	Regular
Power	kW	0.8	1.2	1.5	3	1.5	2
Voltage	V	220 - 240	220 - 240	220 - 240	230	220 - 240	230
Heating time ($\Delta T=45^{\circ}\text{C}$)	h.min	6.13'	4.08'	3.19'	1.40'	3.19'	2.30'
Heat dispersion at 65°C	kWh/24h	1.65	1.65	1.65	1.65	1.56	1.56
Max working pressure	bar	8	8	8	8	8	8
Max working temperature	$^{\circ}\text{C}$	75	75	75	75	75	75
Weight	kg	26	26	26	26	26	26
Class	IP	IPX1	IPX1	IPX1	IPX1	IPX3	IPX3
CODE (UAE)		3201536	3201542	3201982		3201979	
CODE				3201832	3201935	3201828	3201812

NOTE: The Nominal capacity listed in this catalogue identifies the product category.
The actual product capacity is listed in the relative technical documentation.

Pro R Hidden



Electric storage water heater



Features

- / External temperature setting
- / Ecological polyurethane insulation
- / Glasslined inner tank tested at 16 bar
- / Oversize magnesium anode
- / 5-bolts flange
- / Pressure safety valve tested at 8 bar
- / Exclusive Italian design
- / Wall-hung



**save space
with lateral
connection,
up to -20cm**

TECHNICAL DATA

		PRO R HIDDEN 50 H	PRO R HIDDEN 80 H	PRO R HIDDEN 100 H
Nominal Capacity	L	50	80	100
Installation		H	H	H
Size		Regular	Regular	Regular
Power	kW	1.2	1.5	1.5
Voltage	V	230	230	230
Heating time ($\Delta T=45^{\circ}\text{C}$)	h.min	2.17'	2.56'	3.40'
Heat dispersion at 65°C	kWh/24h	1.02	1.48	1.65
Max working pressure	bar	8	8	8
Max working temperature	$^{\circ}\text{C}$	75	75	75
Weight	kg	16.5	22	25.5
Class	IP	IPX1	IPX1	IPX1

OVERALL DIMENSIONS

		PRO R HIDDEN 50 H	PRO R HIDDEN 80 H	PRO R HIDDEN 100 H
A	mm	543	748	900
B	mm	113	113	113
C	mm	163	178	178
D	mm	159	334	486
E	mm	165	100	480
X	mm	165	100	480
Y	mm	165	100	480

CODE

	PRO R HIDDEN 50 H	PRO R HIDDEN 80 H	PRO R HIDDEN 100 H
	3201141	3201142	3201143

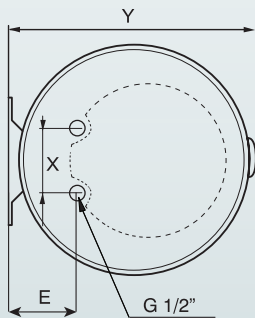
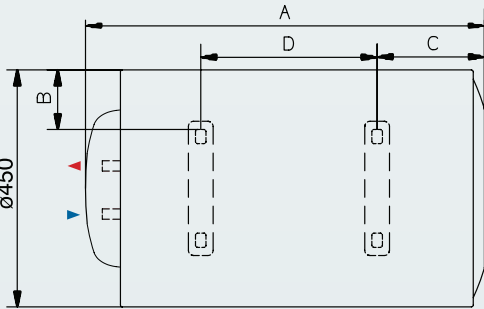

LEGEND

- E** Cold water inlet G 1/2"
- U** Hot water outlet G 1/2"



5 YEARS
WARRANTY



EASY
MAINTENANCE



ENAMELLED
STEEL TANK



EXTERNAL
TEMPERATURE
REGULATION



5 BOLTS
FLANGE

Electric storage water heater



Features

- / External temperature regulation
- / Extra thick polyurethane insulation
- / High thickness steel tank tested at 16 bar
- / Oversized magnesium anode
- / Original Ariston thermostat with built-in safety device
- / External thermometer
- / Pressure safety valve rated at 8 bar
- / Wall-hung



علامة الجودة الإماراتية
Emirates Quality Mark



TECHNICAL DATA		BLU R 50 V	BLU R 80 V	BLU R 100 V	BLU R 50 H	BLU R 80 H	BLU R 80 H	BLU R 100 H	BLU R 100 H
Nominal Capacity	L	50	80	100	50	80	80	100	100
Power	kW	1.5	1.5	1.5	1.2	1.2	1.5	1.2	1.5
Voltage	V	230	230	230	230	220/240	230	220/240	230
Heating time (T= 45°C)	h.min	1.50	2.56	3.40	2.17	3.16	2.56	4.08	3.40
Max. Working Temp.	°C	75	75	75	75	75	75	75	75
Heat dispersion	kWh/24h	0.96	1.22	1.39	1.02	1.48	1.48	1.65	1.65
Max. Working Pressure	bar	8	8	8	8	8	8	8	8
Weight	kg	17	23	25	17	22	23	26	25
Protection	IP	IPX3	IPX3	IPX3	IPX1	IPX1	IPX1	IPX1	IPX1
OVERALL DIMENSIONS									
a	mm	550	758	913	550	758	758	900	913
b	mm	398	603	758	-	-	-	-	-
c	mm	-	-	-	155	174	174	178	177
d	mm	-	-	-	160	335	335	486	487
CODE		3605199	3605200	3605201	3605202	-	3605203	-	3605204
CODE (UAE)		3626201	3626202	3626203	3626204	3623608	3626205	3626315	3626206

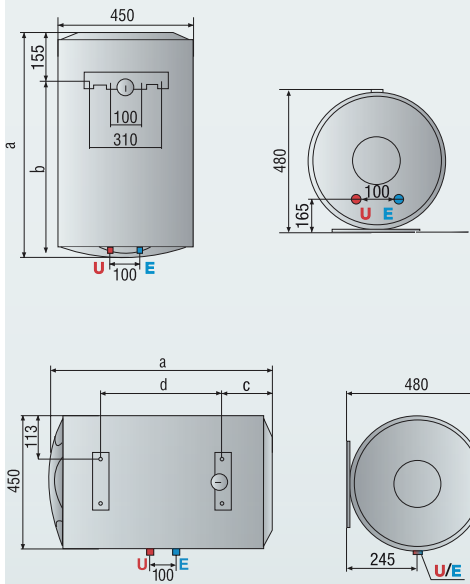

LEGEND
E Cold water inlet G 1/2"
U Hot water outlet G 1/2"

NOTE: The Nominal capacity listed in this catalogue identifies the product category.
 The actual product capacity is listed in the relative technical documentation.



**Small capacity
electric storage
water heaters**



Advanced technologies meet increasingly intelligent performances and unmatched energy savings.

By using different energy sources, Ariston storage water heaters will ensure hot water comfort to all your family.

◆ Andris range

◆ Blu R

Andris range

Compact dimensions, high performance

Small dimensions

Through its use of the storage tank system and the comfort provided by the water heater, Ariston is focused on more compact dimensions. Despite the small dimensions, the three products are capable of satisfying your needs.

Lifespan

The choice of materials is the secret behind the durability of the Andris series of products: each has a copper heating components (heating element) to protect against the effects of corrosion. The more solid structure of the flange limits the risk of leaks and reduces the need for maintenance over time.

Maximum comfort

The Andris water heater is capable of maintaining the high temperature of domestic water for a long period of time through the use of polyurethane insulation which reduces heat loss in the water, increasing your comfort.



ANDRIS LUX ECO
10-15-30 lt



ANDRIS LUX
6-10-15-30 lt



ANDRIS RS
10-15-30 lt

Andris Lux Eco



The energy saving compact electronic water heater

/ Increased energy saving: up to 14% thanks to ECO EVO function which learn habits and optimize production

Features

- / Electronic Display
- / Electronic thermostat
- / Oversized magnesium anode
- / Copper electric heating element
- / Titanium enamelling
- / ABS safety system
- / Easy to install
- / Modern design

Energy Class



Powered by
CoreTECH
Advanced electronic thermostat



TECHNICAL DATA

		ANDRIS LUX ECO 10	ANDRIS LUX ECO 10 U	ANDRIS LUX ECO 15	ANDRIS LUX ECO 15 U	ANDRIS LUX ECO 30
Nominal Capacity	l	10	10	15	15	30
Installation		Oversink	Undersink	Oversink	Undersink	Oversink
Output	kW	1,2	1,2	1,2	1,2	1,5
Voltage	V	220/240	220/240	220/240	220/240	220/240
Heating time ($\Delta T= 45^{\circ}C$)	h. mins	0,30	0,30	0,45	0,45	1,10
Max. operating temp.	$^{\circ}C$	80	80	80	80	80
Heat dispersion at $65^{\circ}C$	kWh/24h	0,46	0,71	0,61	0,61	0,77
Max. operating pressure	bar	8	8	8	8	8
Net weight	kg	6,6	6,6	7,4	7,4	12,8
Protection	IP	X4	X4	X4	X4	X4

DIMENSIONS

		ANDRIS LUX ECO 10	ANDRIS LUX ECO 10 U	ANDRIS LUX ECO 15	ANDRIS LUX ECO 15 U	ANDRIS LUX ECO 30
a	mm	360	360	360	360	446
b	mm	294	294	342	342	406
c	mm	144	144	144	144	165
d	mm	92	92	78	78	115

CODE

	3100345	3100346	3100349	3100350	3100353
Energy class	A	A	A	A	A
Tapping profile	XXS	XXS	XXS	XXS	S

ACCESSORIES

	CODE
Hydraulic safety group 1/2"	877084
Syphon 1"	877086

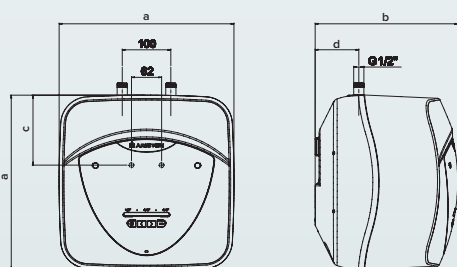
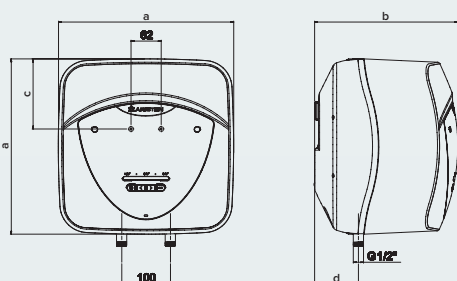

Description

ANDRIS LUX ECO 10/5
ANDRIS LUX ECO 10U/5
ANDRIS LUX ECO 15/5
ANDRIS LUX ECO 30/5

N° of units per pallet

45
45
40
24

NOTE: The Nominal capacity listed in this catalogue identifies the product category. The actual product capacity is listed in the relative technical documentation.

Andris Lux



Easy to use compact electric water heater



10-15-30lt



6lt



Features

- / Front dial to set temperature
- / Mechanical thermostat
- / Oversized magnesium anode
- / Copper electric heating element
- / Titanium enamelling
- / Modern design

Energy Class



TECHNICAL DATA

		ANDRIS LUX 10	ANDRIS LUX 10 U	ANDRIS LUX 15	ANDRIS LUX 15 U	ANDRIS LUX 30
Nominal Capacity	l	10	10	15	15	30
Installation		Oversink	Undersink	Oversink	Undersink	Oversink
Output	kW	1,2	1,2	1,2	1,2	1,5
Voltage	V	220/240	220/240	220/240	220/240	220/240
Heating time ($\Delta T = 45^{\circ}\text{C}$)	hh:mm	00:30	00:30	00:45	00:45	01:10
Max. operating temp.	$^{\circ}\text{C}$	78	78	78	78	78
Heat dispersion at 65°C	kWh/24h	0,46	0,71	0,61	0,85	0,77
Max. operating pressure	bar	8	8	8	8	8
Net weight	kg	6,6	6,6	7,4	7,4	12,8
Protection	IP	X4	X4	X4	X4	X4

DIMENSIONS

		360	360	360	360	447
a	mm	360	360	360	360	447
b	mm	298	298	346	346	410
c	mm	144	144	144	144	165
d	mm	92	92	78	78	114

CODE

	3100641	3100642	3100643	3100650	3100644
Energy class	A	B	A	B	C
Tapping profile	XXS	XXS	XXS	XXS	S
CODE	3100534	3100535	3100536	3100537	3100538

ACCESSORIES

	CODE
Hydraulic safety group 1/2"	877084
Syphon 1"	877086

Andris Lux 10-15-30

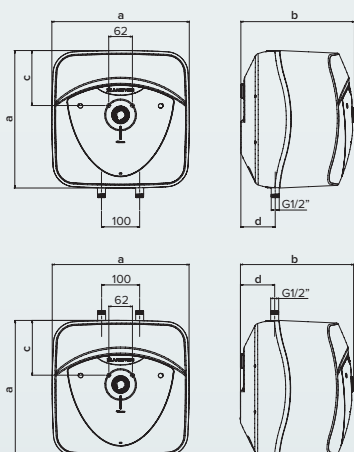

NOTE: The Nominal capacity listed in this catalogue identifies the product category. The actual product capacity is listed in the relative technical documentation.

Andris RS



Compact electric water heater for any need

Features

- / Front dial to set temperature
- / LED indicator
- / Mechanical thermostat
- / Magnesium anode
- / Copper electric heating element
- / Modern design

Energy Class

UP TO **A**



TECHNICAL DATA		ANDRIS RS 10	ANDRIS RS 10 U	ANDRIS RS 15	ANDRIS RS 15 U	ANDRIS RS 30
Nominal Capacity	l	10	10	15	15	30
Installation		Oversink	Undersink	Oversink	Undersink	Oversink
Output	kW	1,2	1,2	1,2	1,2	1,5
Voltage	V	220/240	220/240	220/240	220/240	220/240
Heating time ($\Delta T=45^{\circ}\text{C}$)	h. mins	0,30	0,30	0,45	0,45	1,10
Max. operating temp.	$^{\circ}\text{C}$	78	78	78	78	78
Heat dispersion at 65°C	kWh/24h	0,46	0,71	0,61	0,85	0,77
Max. operating pressure	bar	8	8	8	8	8
Net weight	kg	6,6	6,6	7,4	7,4	12,8
Protection	IP	X1	X1	X1	X1	X1
DIMENSIONS						
a	mm	360	360	360	360	447
b	mm	276	276	324	324	389
c	mm	144	144	144	144	165
d	mm	92	92	78	78	115
CODE (UAE)		3100805	3100806	3100807	3100808	3100809
CODE		3100631	3100632	3100633	3100634	3100635
Energy class		A	B	A	B	C
Tapping profile		XXS	XXS	XXS	XXS	S
		3100329	3100330	3100334	3100335	3100339

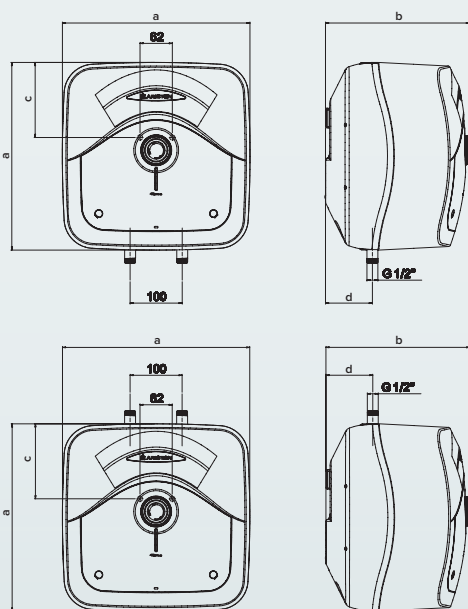

Description	N° of units per pallet
ANDRIS RS 10/5	45
ANDRIS RS 10U/5	45
ANDRIS RS 15/5	40
ANDRIS RS 15U/5	40
ANDRIS RS 30/5	24

ACCESSORIES	CODE
Hydraulic safety group 1/2"	877084
Syphon 1"	877086

NOTE: The Nominal capacity listed in this catalogue identifies the product category. The actual product capacity is listed in the relative technical documentation.

Blu R



ENAMELLED
STEEL TANK



POLYURETHANE
INSULATION



TEMPERATURE
REGULATION



ANTI-FREEZE



Compact electric water heater for any need

Features

- / External temperature regulation
- / Ecological thick polyurethane insulation
- / High sensitivity thermostat
- / High thickness steel tank tested at 16 atm
- / Oversized magnesium anode
- / Glasslined inner tank
- / Pressure safety valve rated at 8 bar
- / Wall-hung



customizable comfort

TECHNICAL DATA

		BLU R 10 OR	BLU R 10 UR	BLU R 15 OR	BLU R 15 UR	BLU R 30
Capacity	l	10	10	15	15	30
Power	kW	1,2	1,2	1,2	1,2	1,5
Voltage	V	230	230	230	230	230
Heating time (delta T=45°C)	h,min0	,290	,290	,44	0,44	1,10
Max heating temperature*	C8	08	08	08	08	0
Heat dispersion	kWh/24h0	,430	,550	,530	,650	,61
Max working pressure	bar8		88		88	
Weight	kg	6,4	6,4	7,1	7,2	12
Protection	IP	IPX1	IPX1	IPX1	IPX1	IPX1

OR= oversink
UR= undersink

OVERALL DIMENSIONS

	mm	3603	60	3603	60	446
a	mm	3603	60	3603	60	446
b	mm	254	254	3003	00	360
c	mm	3603	60	3603	60	446
d	mm	92	92	78	78	115
e	mm	144	144	144	144	165

CODE

3605462 3605463 3605464 3605465 3605466

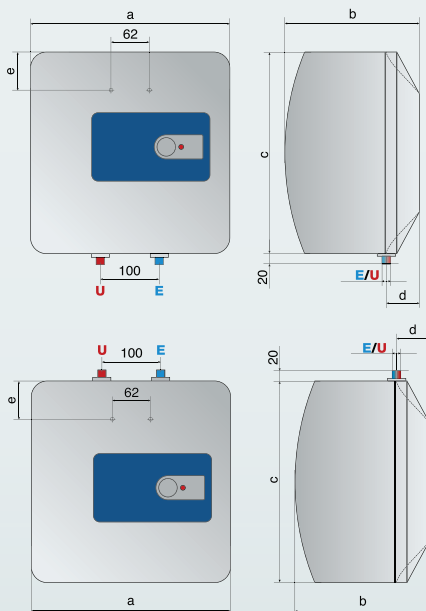

LEGEND

E Cold water inlet G 1/2"
U Hot water outlet G 1/2"

NOTE: The Nominal capacity listed in this catalogue identifies the product category.
The actual product capacity is listed in the relative technical documentation.



**Big capacity
electric storage
water heaters**



Floor standing big capacity electric water heater up to 300L for big needs

Features

- / Quick heating thanks to the two heating element of 4,5 kW
- / Ecological polyurethane insulation
- / T&P safety valve
- / 10 bar pressure safety valve
- / Titanium glasslined inner tank tested at 16 bar
- / Oversize magnesium anode
- / 5-bolts flange
- / Exclusive Italian design



two by 4,5kW heating element

TECHNICAL DATA

		ARI TOP 160 230V MO	ARI TOP 200 230V MO	ARI TOP 300 230V MO	ARI TOP 300 415V TR
Nominal Capacity	l	160	200	300	300
Power	kW	4,5kW / 4,5 kW*	4,5kW / 4,5 kW*	4,5kW / 4,5 kW*	4,5 kW + 4,5 kW**
Voltage	V	230	230	230	400 - 415
Phase		Mono-phase	Mono-phase	Mono-phase	Tri-phase
Installation		Floor Standing	Floor Standing	Floor Standing	Floor Standing
Diameter	mm	560	560	560	560
Anode		Magnesium	Magnesium	Magnesium	Magnesium
Protection	IP	IPX1	IPX1	IPX1	IPX1
Inner tank		Enameled	Enameled	Enameled	Enameled
Working pressure	bar	10	10	10	10

OVERALL DIMENSIONS

	mm	1089	1331	1857	1857
a	mm	1058	1299	1825	1825
b	mm	238	250	254	254
c	mm	291	310	314	314
d	mm	651	822	1174	1174
e	mm	360	512	860	860
f	mm				

* The heating element will not work together, maximum absorption power of 4,5 kW.

** Heating elements will work simoltanuesly. Max absorbtion 9kW.

CODE

3060339	3060340	3060341	3060344
---------	---------	---------	---------

NOTE: The Nominal Capacity listed in this catalogue identifies the product category. The actual product capacity is listed in the relative technical documentation.

LEGEND

- E** Cold water inlet G 1"
- U** Hot water outlet G 1"



Floor standing electric water heater up to 300L for big needs

Features

- / Elegant design
- / Titanium enamelling
- / Magnesium anode
- / Easily removed inspection flange
- / High IP protection rating



TECHNICAL DATA

		ARI 150 V THER	ARI 150 H THER	ARI 200 V THER	ARI 200 H THER
Nominal Capacity	L	150	150	200	200
Power	kW	1.8	2	2.2	2
Voltage	V	230	230	230	230
Heating time (deltaT= 50°C)	h.min	5.10	4.40	5.35	5.50
Heat dispersion	kWh/24h	1.41	1.68	1.85	2.06
Max working temp.	°C	65	75	65	75
Protection	IP	IP25D	IP25	IP25D	IP25
Weight	kg	37	39	45	47

OVERALL DIMENSIONS

		ARI 150 V THER	ARI 150 H THER	ARI 200 V THER	ARI 200 H THER
a	mm	750	750	1050	1050
b	mm	500	500	800	800
c	mm	1010	1020	1270	1285
d	mm	230	230	230	230
e	mm	175	180	175	180
f	mm	560	570	560	570
g	mm	575	585	575	585
h	mm	G3/4	G3/4	G3/4	G3/4

CODE (UAE)

ARI 150 V THER	ARI 150 H THER	ARI 200 V THER	ARI 200 H THER
3010909	3010907	3010910	3010908

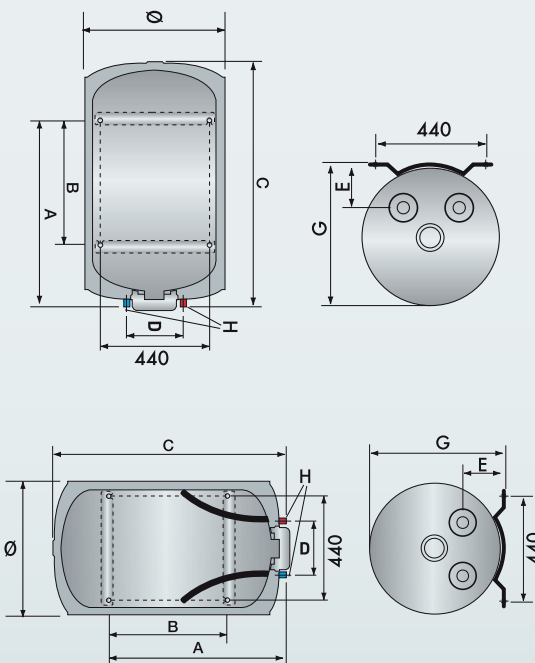

LEGEND

- E** Cold water inlet G 3/4"
- U** Hot water outlet G 3/4"

NOTE: The Nominal capacity listed in this catalogue identifies the product category. The actual product capacity is listed in the relative technical documentation.



Floor standing big capacity electric water heater up to 300L for big needs

Features

- / High V40
- / Ecological polyurethane insulation
- / Titanium glasslined inner tank tested at 12 bar
- / Oversize magnesium anode
- / 6-bolts flange
- / Pressure safety valve rated at 6 bar
- / Exclusive Italian design
- / Floor Standing



ARI 200
ARI 250
ARI 300

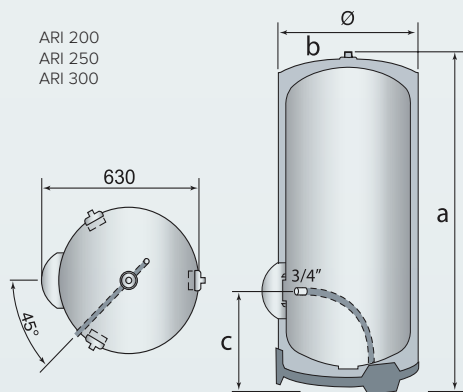

LEGEND

- Cold water inlet G 1"
- Hot water outlet G 1"

TECHNICAL DATA		ARI 200 STAB	ARI 250 STAB	ARI 300 STAB
Nominal Capacity	L	200	250	300
Power	kW	3.0	3.0	3.0
Voltage	V	230/400	230	230/400
Heating time (ΔT= 45°C)	h.min	4.26	5.00	5.54
Max. Working Temp.	°C	70	70	70
Heat dispersion	kWh/24h	1.88	2.17	2.6
Max. Working Pressure	bar	6	6	6
Protection	IP	IP25D	IP25D	IP25D
Weight	kg	50	61	71
OVERALL DIMENSIONS				
a	mm	1300	1560	1820
b	mm	570	570	570
c	mm	365	365	365
CODE (UAE)		3010911		3010912
CODE				
Without Safety Valve - 230V		3000595	3000596	3000597
With Safety Valve - 230V		3000618		3000619
With Safety Valve - 230/400V		3000620		3010871

NOTE: The Nominal capacity listed in this catalogue identifies the product category. The actual product capacity is listed in the relative technical documentation.



**Electric
instantaneous
water heaters**

New compact Aures range

Hyper speed, instant comfort



Instant heating technology

Instant comfort and unlimited hot water



Aures electric instant water heater uses electricity to **instantly deliver hot water at the desired temperature** thanks to its compact 0.4 l tank equipped with a **powerful heating element** which heats water as soon as it flows through the unit. Aures is **available in a wide range of power options** (from 2kW to 36 kW) to satisfy any need. With Aures Pro, the water temperature is kept constant at the desired level due to the action of the **high-performing thermostatic technology**.



Aures' compact size allows **simple installation also in narrow spaces** like the shower box or under the sink. **Easy maintenance and quick replacement** of the internal components are ensured.

Energy class A

The ultimate energy efficient solution

Aures is the most efficient way to provide hot water at the point of use. The whole Aures range boasts ErP energy class A, achieving top level of energy efficiency in the electric water heating segment. **All the electricity** taken from the electric network **is converted** into the necessary amount of hot water needed by the user. **The water is not pre-heated** and it is not stocked in a tank: an effective approach to **eliminate heat loss and reduce energy consumption**.

Total safety system

The peace of mind you are longing for

The **double pole Earth Leakage Circuit Breaker (ELCB)** prevents electric shocks, integrating with a total safety device system that **avoids the damage of the product**. If a dangerous voltage is detected, the device will interrupt the electrical circuit as a safety measure. Thanks to the excellent protection of the product against the ingress of water, **Aures Slim single point can be placed inside the shower space**.

Your guide to define the right model for every need

1 Choose the suitable range for your needs and infrastructure

Installation

How many water points do you want to supply?

/ One point (Single Point) → Aures Slim range

/ More than two points (Multi Point) → Aures Slim Multi & Aures Pro range

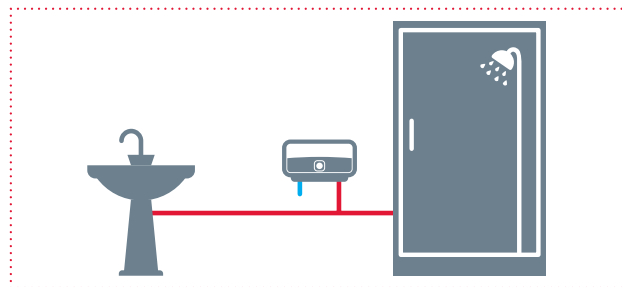
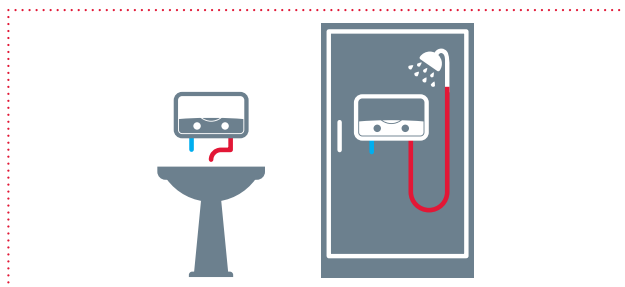

Correct installation

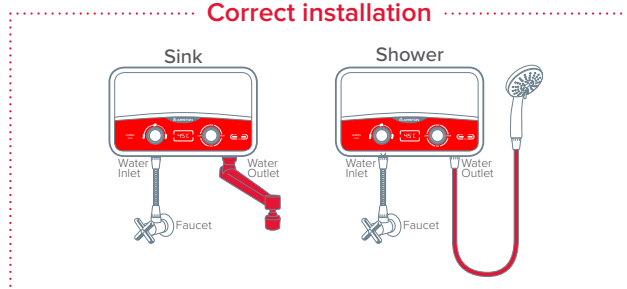

Correct installation

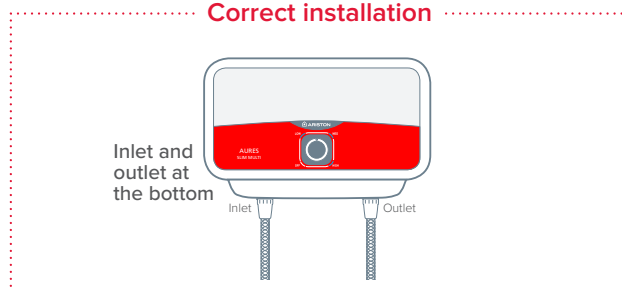

Incorrect installation

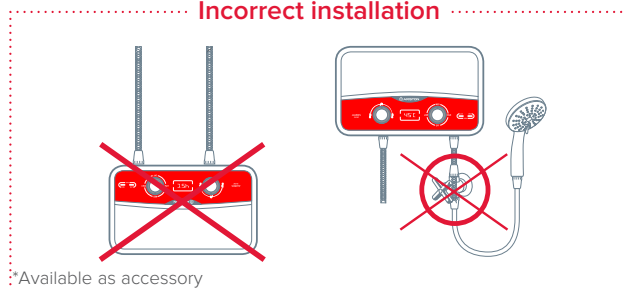

*Available as accessory

Incorrect installation

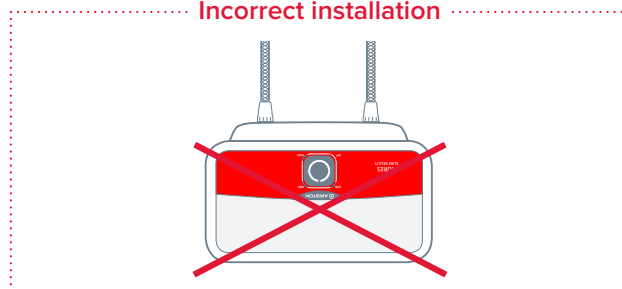

Single Point supplies only one water point directly connected to the appliance (unpressurized)

Multi Point can supply more water points at the same time (pressurized)

Quality Electric Network

Check the electric network features such as Power [kW], Ampere, Phase and the current consumption of the place where the product will be installed.

Usage

Which water points would you like to use (Tap, Shower, Bath)?

/ Based on the preferred water point the **average temperature** and **water flow** will differ.

/ Refer to the table below to understand the average flow rate for each water point:

WATER POINT	AVERAGE WATER FLOW
TAP	2-4 l/min
SHOWER	5-7 l/min
BATH	12-14 l/min
24	17,2

This is an estimation and it varies according to the geographical location.



2 Identify the right power needed

Which power (kW) is right for you?

There are two external factors which impact the power supply:

/ **Inlet Temperature:** what is your average ground water temperature?

/ **Water Flow:** how much water do you use at your peak time?

Example: the power needed for a simulated flow rate data for Δ Temperature ($^{\circ}$ C) = 20 $^{\circ}$ C, calculated using the formula

$$\text{Power} = \text{Flow Rate} \times \Delta\text{Temperature} \times 0,07$$

POWER [kW]	Δ TEMPERATURE [$^{\circ}$ C]	FLOW RATE [l/min]
4,9	20	3,5
9	20	6,5
12	20	8,6
24	20	17,2

Aures Slim



ITALIAN
DESIGN



COMPACT
SIZE



EXTERNAL
POWER
REGULATION



IP25
WATERPROOF



DOUBLE
SAFETY
THERMOSTAT



SINGLE POINT

Single point instant water heater



- / Flexible installation: with compact design and water protection IP25 it can be installed inside shower box
- / Safe and secure thanks to double thermal cut out thermostat which prevent scalding

Features

- / Easy to install
- / Shower head & tap accessory
- / Knob power setting (4 levels) and 2 LED
- / Italian design
- / Support one water point connected directly to the product



TECHNICAL DATA

AURES S
3,5 SH UAE

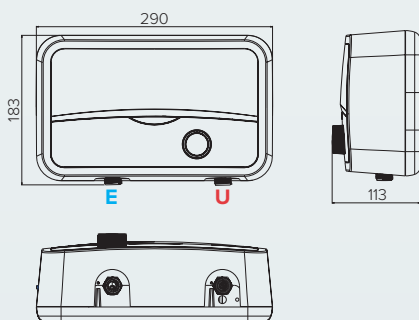

Voltage	V	220-240
Power	kW	3,5
Step Power	kW	1,5+2
Phase		Mono
Ampere at 220V		15,9
Frequency	Hz	50/60
Heating element		Copper
MIN Working Pressure	bar	0,3
MAX Working Pressure	bar	8
IP protection degree		IP25
Max working temperature	°C	55
Cable & Plug		no
Shower/Tap kit		A

CODE



3520219-V

Energy class	A
Tapping profile	XXS

KEY

- E** \ Cold water inlet G 1/2"
- U** \ Hot water outlet G 1/2"

The capacity indicated in this catalogue identifies the product category. The effective capacity of the product is given in the relevant technical documentation provided with the product.

Aures Slim Flow



ITALIAN DESIGN



COMPACT SIZE



POWER AND TEMPERATURE MANAGEMENT



IP25 WATERPROOF



DOUBLE SAFETY THERMOSTAT



SINGLE POINT

Single point instant water heater



- / Flexible installation: with compact design and water protection IP25 it can be installed inside shower box
- / Safe and secure thanks to double thermal cut out thermostat which prevent scalding

Features

- / Easy to install
- / Shower head & tap accessory
- / Knob power setting (4 levels) and 2
- / Italian design
- / Support one water point connected directly to the product



TECHNICAL DATA

AURES SF
5,5 COM EU

Voltage on tech label	V	220-240
Power	kW	5,5
Step Power	kW	2,2 + 3,3
Phase		Mono
Ampere at 220V		25
Frequency	Hz	50/60
Heating element		Copper
MIN Working Pressure	bar	0,3
MAX Working Pressure	bar	8
IP protection degree		IP25
Max working temperature	°C	55
Cable & Plug		no
Shower/Tap kit		E

CODE



3520220-V

Energy class	A
Tapping profile	XS

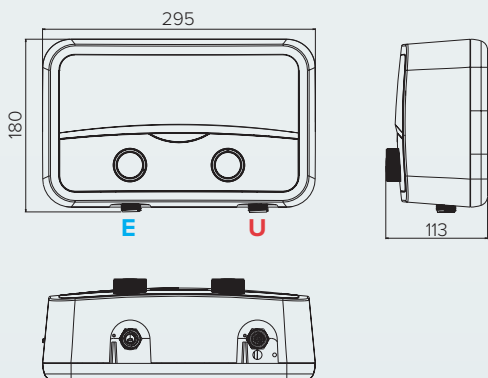

KEY

- E \ Cold water inlet G 1/2"
- U \ Hot water outlet G 1/2"

The capacity indicated in this catalogue identifies the product category. The effective capacity of the product is given in the relevant technical documentation provided with the product.

Single point / Accessory Aures Slim

Model Name and composition

KIT A - ENTRY

- White Shower Head 3 Spray
- White Hose
- White hook

KIT B - TAP

- White Tap

KIT C - PREM

- Chrome Shower Head 3 Spray
- Chrome Hose
- Chrome hook

KIT D - PREM BAR

- Chrome Shower Head 3 Spray
- Chrome Hose
- Slide Bar

KIT E - COMBI = KIT A + KIT B

- White Shower Head 3 Spray
- White Hose
- White hook
- White Tap



Aures Multi NEW



ITALIAN DESIGN



EXTERNAL POWER REGULATION



COMPACT SIZE



EASY INSTALLATION



ENERGY EFFICIENT



DOUBLE SAFETY THERMOSTAT



MULTI POINT

Multi point instant water heater with premium design



- / Flexible installation: with compact design and water protection IP25 it can be installed inside shower box
- / Safe and secure thanks to double thermal cut out thermostat which prevent scalding
- / Practical thanks to flow sensor which activate the product only when user turn on the tap

Energy Class



Features

- / Easy to install
- / Knob power setting (4 levels) and 3 LED
- / Italian design
- / Support multiple water point connected directly to the product



TECHNICAL DATA

AURES SM 7.7 UAE

Voltage	V	220-240
Power	kW	7.7
Step Power	kW	3,3 + 4,4
Phase		Mono
Ampere at 220V		35
Frequency	Hz	50/60
Safety Valve	Y/N	Y
Heating element		Copper
Min flow rate	L/MIN	2,1
MAX Working Pressure	bar	8
IP protection degree		IP25
Max working temperature	°C	55
Cable & Plug		No

OVERALL DIMENSIONS

A	mm	180
B	mm	304
C	mm	110

CODE



3195237

Energy class	A
Tapping profile	XS

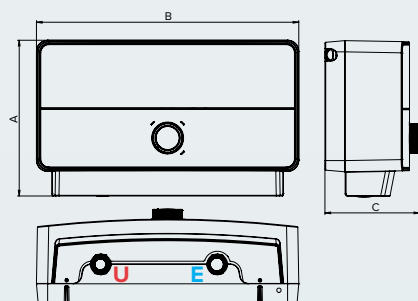

KEY

- E \ Cold water inlet G 1/2"
- U \ Hot water outlet G 1/2"

The capacity indicated in this catalogue identifies the product category. The effective capacity of the product is given in the relevant technical documentation provided with the product.

* Ampere at 400V



**Commercial
electric
water heaters**

Floor standing big capacity electric water heater up to 500L for big needs



Features

- / Elegant design
- / Titanium enamelling
- / Magnesium anode on the top
- / Easily removed inspection flange, where there is an inspectionable additional flange
- / High IP protection rating
- / Insulation in hard polyurethane mould-injected. Outer case available in soft jacket only.
- / Water Outlet on the side
- / Delivered with no carton box, but packaged on a pallet with a film

TECHNICAL DATA

TI 500 STI EU

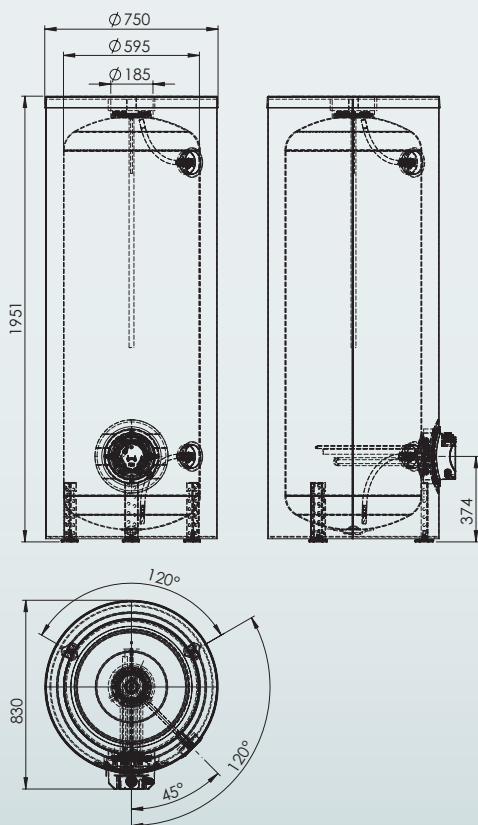

Capacity	l	462
Tank diameter	mm	Ø595
External diameter	mm	Ø758
PU thickness	mm	75
Dimensions product	cm	76 X 83 X 195
Dimensions packaging	cm	82 X 82 X 216
Gross weight	kg	125
Net weight	kg	107
Heating time	h	3,50"
Max Working Temp.	°C	90
Heat dispersion	kWh/day	1,92
Max Working Pressure	bar	6
Protection		IP24
ErP Energy efficiency	η_{wh}	0,3946
ErP Q elec	kWh/day	19,09
ErP Annual consumption (AEC)	kWh/year	4192
ErP V40	l	836
Voltage requirements	V/Ph/Hz	230/1/50-60

CODE



3070547

Energy class

C

Tapping profile

XL

ACCESSORI

Codice

Hydraulic Safety group 3/4"

877085

Hydraulic Safety group 1"

885516

Siphon 1"

877086

KEY

E \ Cold water inlet G 3/4" (200-300) G 1" (500)

U \ Domestic hot water outlet G 3/4" (200-300) G 1" (500)

NOTE: The Nominal capacity listed in this catalogue identifies the product category. The actual product capacity is listed in the relative technical documentation.



- / Flexibility of configuration
- / Quick recovery time
- / Double thermostat
- / Fully pre-assembled product
- / Two types of control panels built-in:
 - Simple pannel for an easy control
 - Full pannel for a complete overview on working conditions
- / Incoloy 800 heating element with low surface change
- / Oversize magnesium anode
- / Inspection flange for easy maintenance (D = 110 mm)
- / Soft polyurethane insulation
- / Max working pressure of 8 bar
- / Building Management System (BMS): possibility to remote the control pannel

TECHNICAL DATA		ES EXTRA 500	ES EXTRA 750	ES EXTRA 1000	ES EXTRA 1500	ES EXTRA 2000	ES EXTRA 2500	ES EXTRA 3000
Nominal Capacity*	L	500	750	1000	1500	2020	2500	3000
Max working pressure	bar	8	8	8	8	8	8	8
Empty weight	kg	110	170	190	310	381	461	506
Max heating element	Nr	2	3	3	3	4	5	5
Cold water inlet		R 2" GM	R 2" GM	R 2" GM	R 2" GM	R 2" GM	R 2" GM	R 2" GM
Hot water outlet		R 2" M	R 2" M	R 2" M	R 2" M	R 2" M	R 2" M	R 2" M
Recirculation		R 1 1/2 GM	R 1 1/2 GM	R 1 1/2 GM	R 1 1/2 GM	R 1 1/2 GM	R 1 1/2 GM	R 1 1/2 GM
Drain		Rp 1 1/4 G	Rp 1 1/4 G	Rp 1 1/4 G	Rp 1 1/4 G	Rp 1 1/4 G	Rp 1 1/4 G	Rp 1 1/4 G
Probe connection		Rp 3/8" G	Rp 3/8" G	Rp 3/8" G	Rp 3/8" G	Rp 3/8" G	Rp 3/8" G	Rp 3/8" G
DIMENSIONS								
A	mm	850	990	990	1200	1400	1450	1550
B	mm	650	790	790	1000	1200	1250	1350
C	mm	1905	1945	2345	2335	2245	2410**	2420**
D	mm	530	575	560	595	705	615	540
E: Water Inlet	mm	250	290	290	365	435	345	270
F: Recirculation	mm	1070	1030	1210	1275	1205	1250	1410
G	mm	1000	1140	1140	1350	1700	1750	1850

*The Nominal capacity listed in this catalogue identifies the product category. The actual product capacity is listed in the relative technical documentation.
 ** with feet installed

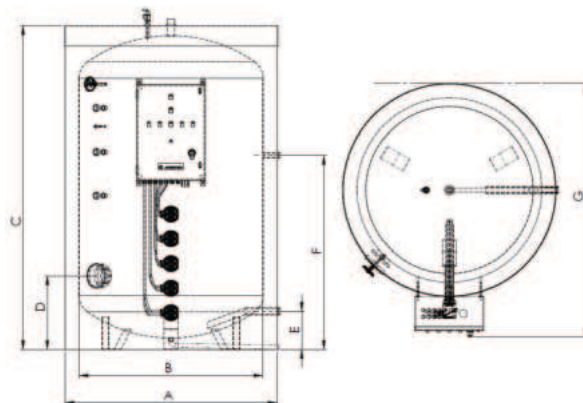

PERFORMANCE DATA		500-12	500-24	750-12	750-24	750-36	1000-12	1000-24	1000-36	1500-12	1500-24
Power	kW	12	24	12	24	36	12	24	36	12	24
Panel***		SB-SF	SB-SF	SB-SF	SB-SF	SB-SF	SB-SF	SB-SF	SB-SF	SB-SF	SB-SF
Voltage	V	400	400	400	400	400	400	400	400	400	400
Heating Elements		1	2	1	2	3	2	2	3	2	2
Recovery time DT 40°C rise	min.	116	58	174	87	58	233	116	78	349	174
Recovery time DT 45°C rise	min.	131	65	196	98	65	262	131	87	392	196
Flow rate 40°C rise	l	258	516	258	516	774	258	516	774	258	516
Flow rate 45°C rise	l	229	459	229	459	688	229	459	688	229	459
First hour delivery 40°C rise	l	608	866	783	1041	1299	958	1216	1474	1308	1566
First hour delivery 45°C rise	l	579	809	754	984	1213	929	1159	1388	1279	1509

*** SB = Basic panel - SF = Full panel

CODE

With soft jacket - Basic panel	3080029	3080081	3080260	3080273	3080274	3080333	3080334	3080335	3080336	3080337
With soft jacket - Full panel	3104098	3104099	3104101	3104102	3104103	3104104	3104105	3104106	3104107	3104108

PERFORMANCE DATA		1500-36	2020-24	2020-36	2020-48	2500-36	2500-48	2500-60	3000-48	3000-60	3000-80
Power	kW	36	24	36	48	36	48	60	48	60	80
Panel***		SB-SF	SF	SF	SF	SF	SF	SF	SF	SF	SF
Voltage	V	400	400	400	400	400	400	400	400	400	400
Heating Elements		3	2	3	4	3	4	3	4	5	5
Recovery time DT 40°C rise	min.	116	233	155	116	194	145	116	174	140	105
Recovery time DT 45°C rise	min.	131	262	174	131	218	164	131	196	157	118
Flow rate 40°C rise	l	774	516	774	1032	774	1032	1290	1032	1290	1720
Flow rate 45°C rise	l	688	459	688	917	688	917	1147	917	1147	1529
First hour delivery 40°C rise	l	1824	1916	2174	2432	2524	2782	3040	3132	3390	3820
First hour delivery 45°C rise	l	1738	1859	2088	2317	2438	2667	2897	3017	3247	3629

*** SB = Basic panel - SF = Full panel

CODE

With soft jacket - Basic panel	3080338										
With soft jacket - Full panel	3104109	3080339	3080340	3080341	3080342	3080343	3080344	3080345	3080346	3080347	

The capacity indicated in this catalogue identifies the product category. The effective capacity of the product is given in the relevant technical documentation provided with the product.

Es Extra 5000



- / Flexibility of configuration
- / Quick recovery time
- / Double thermostat
- / Fully pre-assembled product
- / Full panel for a complete overview on working conditions
- / Incoloy 800 heating element with low surface change
- / Oversize magnesium anode
- / Inspection flange for easy maintenance (D= 400 mm)
- / Soft polyurethane insulation
- / Max working pressure of 8 bar
- / Building Management System (BMS): possibility to remote the control panel

TECHNICAL DATA

ES EXTRA
5000

Capacity	L	4901
Max working pressure	bar	8
Empty weight	kg	1030
Max number of heating element	Nr	6
Cold water inlet		R 3" M
Hot water outlet		R 3" M
Recirculation		R 2" M
Drain		R 1 1/2" M
Probe connection		Rp 3/4" M

DIMENSIONS

A: external diameter	mm	1910
B: tank diameter	mm	1750
C: overall height, water outlet pipe	mm	2710
D: water inlet pipe	mm	1105
E: water recirculation pipe	mm	865
F: inspection flange	mm	1805
G: depth	mm	2220

PERFORMANCE DATA

		5000-48	5000-60	5000-80	5000-96
Power	kW	48	60	80	96
Panel***	SF	SF	SF	SF	SF
Voltage		400	400	400	400
Heating Elements		4	5	5	6
Recovery time DT 40°C rise	min	291	233	174	145
Recovery time DT 45°C rise	min	327	262	196	164
Flow rate 40°C rise	l	1032	1290	1720	2064
Flow rate 45°C rise	l	917	1147	1529	1835
First hour delivery 40°C rise	l	4532	4790	5220	5564
First hour delivery 45°C rise	l	4417	4647	5029	5335

*** SB = Basic panel - SF = Full panel

CODE With soft jacket - Full panel

3080348 3080349 3080350 3080351

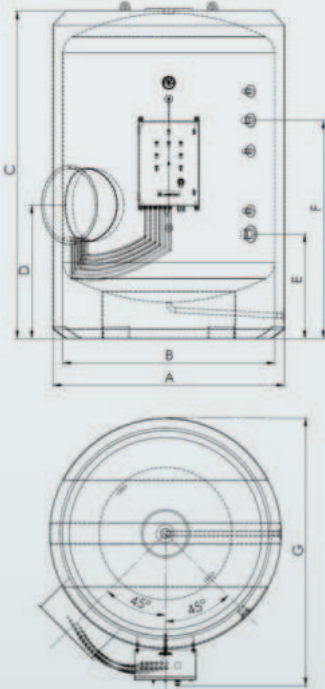

The capacity indicated in this catalogue identifies the product category. The effective capacity of the product is given in the relevant technical documentation provided with the product.

How to read the symbols

The icons have been designed to facilitate the reading of the features of each product. Ariston makes it possible, from the very beginning, to quickly and easily identify performance levels, understand the different ranges and evaluate purchasing criteria.

In short, users can familiarise themselves with each machine without becoming confused or wasting time, in line with the Ariston philosophy of always offering the customer - and the professional technician - a service which is clear and easy to use.



SUPER SILENT

Silent functioning, respectful of the quiet of your everyday life



ENERGY EFFICIENT

Better exploitation of energy and renewable sources, enhanced performance



ITALIAN DESIGN

The elegant aesthetics is designed in collaboration with Italian designers, an attention to details that dares to be shown off



SYSTEM MANAGEMENT

Manage all Ariston products connected in system thanks to BusBridgeNet® technology



MADE IN EUROPE

Made in Europe



ANTI-CORROSION

Longer durability and high performance thanks to the anti-corrosion Pro-tech technology



EASY INSTALLATION

Installation time and process optimized in cooperation with experts and professionals



SOLAR INTEGRATION

It can be connected in system with Ariston solar-sourced products



MADE IN ITALY

Made in Italy



AG+ COATING

AG+ cartridge technology with antibacterial capability that actively stop the proliferation of E-Coli, Salmonella, Legionella, Mould Fungi & More.



EASY INSPECTION

Large inspection flange for an easier access to the internal components of the products



OUTDOOR INSTALLATION

Designed to be safely installed outside, resistant to all kinds of weather



COMPACT SIZE

Compact design with reduced dimensions for an easy fit at your home



EASY MAINTENANCE

Frontal access to all main components



ECO EVO FUNCTION

Automatic setting of its functioning based on your habits and needs of hot water



ANTI-LEGIONELLA

Automatic water heating cycle to prevent bacterial growth



ANTI-FREEZING

Works at cold temperature



INVERTER TECHNOLOGY

Frequency modulation of the external unit compressor



SOLAR KEYMARK

Compliant with European quality certification for solar systems



ELECTRONIC TEMPERATURE MANAGEMENT

Electronic control panel for easier, more intuitive operation.



TITANIUM PLUS

Longer durability and resistance to corrosion thanks to the Titanium enameling of the water tank



INTEGRATION WITH PHOTOVOLTAIC SYSTEM

Connection with photovoltaic systems



Wi-Fi

Smart Connectivity - Aqua Ariston Net App



WATER PLUS

It keeps the incoming cold water at the bottom of the tank to ensure reduced mixing with stored hot water



ABSOLUTE SAFETY SYSTEM

It is a set of functions preserving the good functioning of the product in case of energy or water failures



INCOLOY ENAMELED HEATING ELEMENT

It is corrosion resistant and reduces limescale



TITAN SHIELD

It is an anti-corrosion and rust-resistant protective technology which prevents the surface from corroding even when it is in contact with warm water



DIGIT DISPLAY

Easy interaction and easy temperature management thanks to the advanced hi-tech digit display



LED DISPLAY

Simple and intuitive multifunction LED display



DOUBLE SAFETY THERMOSTAT

In case of malfunctioning, the precise thermostat blocks heating cycle before reaching too high temperature



HIGH EFFICIENCY INSULATION

Premium and robust environmental-friendly insulation material made up of Cyclopentane



DISPLAY ECO

Frontal led control panel with smart thermometer



SHOWER READY

It shows when enough water has been heated for a shower



i-MEMORY

Function that learns your habits and chooses accordingly the best option between utilizing the renewable energy of the heat pump, and activating the heating element



DRY HEATING ELEMENT

The heating element is not in direct contact with water for long lasting durability and limescale protection



SAFETY PACKAGE

Set of functions preserving the good functioning of the product in case of energy or water failures



HAIL-PROOF

Hail-resistant thick glass



STABLE TEMPERATURE

Outlet temperature remains stable even in the case of flow rate variation



IP25 WATERPROOF

The TOP level in water protection guarantees a safety installation in shower box



CONSTANT TEMPERATURE

Hot water and constant temperature right when you need them, in every condition and regardless of any external factor (water flow, water's original temperature)



SINGLE POINT

It is corrosion resistant and reduces limescale



MULTI POINT

Can supply more water points at the same time (pressurized)



FLAT

Low depth for space saving and easy fitting at your home



ELECTRONIC TEMPERATURE MANAGEMENT

Electronic thermostat ensures an increase of energy saving and prevents scalding thanks to anti-overheating features.



POWER AND TEMPERATURE MANAGEMENT

Flow regulation knob plus temperature regulation knob and 4 steps axial regulation power to set the desired energy consume



MUTIPOSITION

Flexible installation, vertical or horizontal position



PERFORMANCE PLUS

Enhanced performance thanks to the high quality material selection to increase heat absorption and limit heat dispersion



EXTERNAL TEMPERATURE REGULATION EXTERNAL POWER REGULATION

Easy setting of the temperature/power, thanks to the external controller

After-sales service



First class service

Ariston service model is designed to offer efficiency and professionalism to all its customers.



Genuine Ariston spare parts

All Ariston spare parts are built and tested to guarantee the best possible quality and the reliability of your Ariston product. Using genuine Ariston spare parts and components is the only way to keep your system at its best, fulfilling legal and warranty requirements.



Maximum peace of mind

Ariston gives you the assurance of long-term product quality and safety, and in case of any potential problem it ensures that everything will be dealt with quickly and professionally.

Look up the closest service center at ariston.com/me
or call the Ariston Customer Service at the **toll-free number 800-2747866**





ariston.com